



www.frontrangecommercial.com

PPCIE # 28759180

Warehouse Building For Sale or Lease

800 West 2nd St
Pueblo, CO

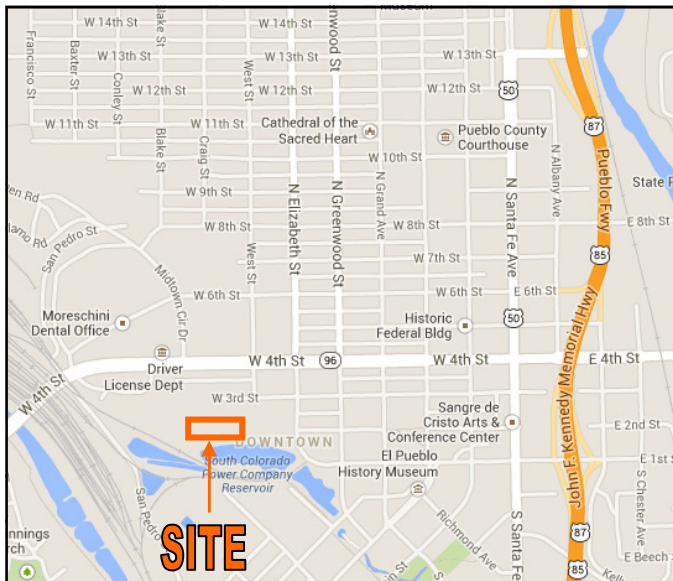

LOCATION: Downtown just west of North Elizabeth Street and West 2nd Street

BUILDING SIZE: Total 12,800sqft
3 Warehouse Bays 3,600sqft each
Office/production 2,000sqft
Building is divisible

LAND AREA: 1.5 Acres

ZONING: I-2 allows most industrial warehouse uses

SALE PRICE: \$498,000.00

LEASE RATE: \$6,000.00/month NNN

Amenities:

- 14ft to 20Ft clear height ceilings
- 1200amp, 3 phase electric power
- 3 dock high over head doors with dock levelers
- 2 drive in over head doors
- Fenced yard area
- Active rail spur service
- 1/2 mile from interstate 25

CONTACT:

Jay Carlson
(719) 520-9500

carlson@frontrangecommercial.com



REALTORS® COMMERCIAL AND INDUSTRIAL SOCIETY

105 E. Moreno Ave., Second Floor, Colorado Springs, CO 80903, Ph 719-520-9500 Fx 719-520-1043

All information is from sources deemed reliable and is submitted subject to errors, omissions, change of price, rental, prior sale and withdrawal without notice.

USERS OF THIS INFORMATION SHOULD BE CAREFUL TO VERIFY EVERY ITEM OF INFORMATION CONTAINED HEREIN.

800 West 2nd Street FLOOR PLAN

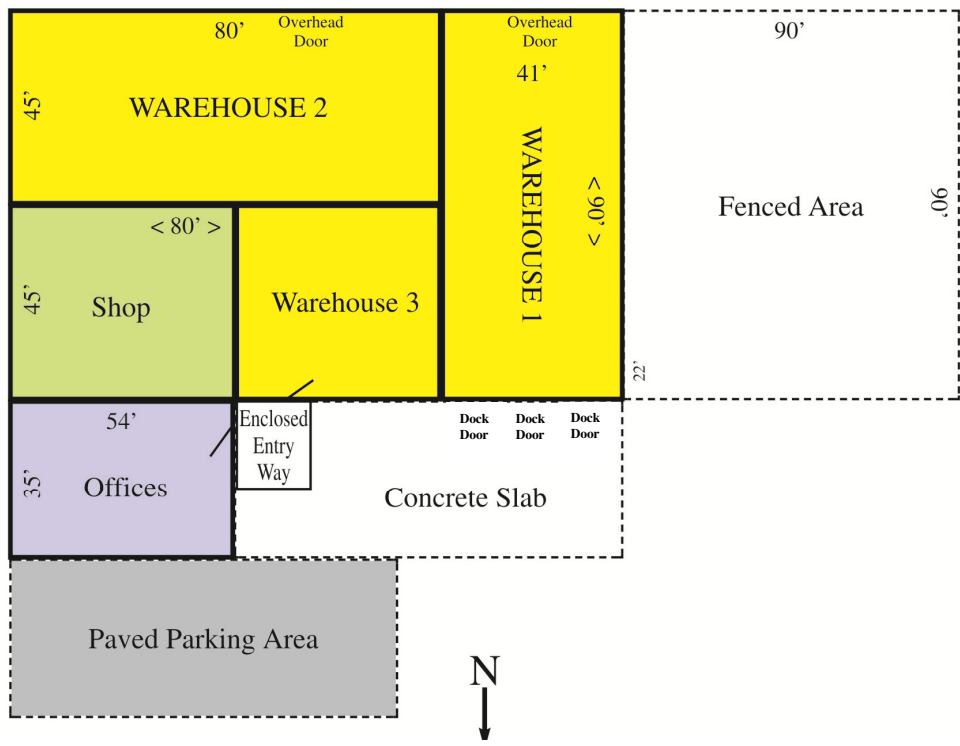

AERIAL

